

# Female Catheterization and Rectal Injection Model type II

LM-025

## Instruction Manual

Thank you for purchasing Female Catheterization and Rectal Injection Model type II.  
Please read this instruction manual carefully to ensure correct use of the product,  
and store it in a safe place for easy access.

KOKEN CO., LTD.

1-4-14 Koraku, Bunkyo-ku, Tokyo 112-0004 JAPAN

URL:<http://www.kokenmpc.co.jp>

E-mail:[customer@kokenmpc.co.jp](mailto:customer@kokenmpc.co.jp)



## Handling and Safety Precautions

**These precautions should be strictly observed in order to ensure safe, long-term use of the product.**

### The following precautions should be observed particularly strictly:

- This model is made of special silicon that provides lifelike sensations. Therefore, handle the model as carefully as you would when handling real human body.
- To practice urethral catheterization or glycerin rectal injection, fully apply glycerin or other similar lubricant to the catheter or the simulated glycerin rectal injector.
- Do not use the supplied catheter and simulated glycerin rectal injector for the living body.
- The glycerin rectal injector is designed to send 50 ml at a flow rate of more than 15 seconds. If the flow rate is too fast or if the drainage tube is positioned upward during practice, liquid leakage may result.

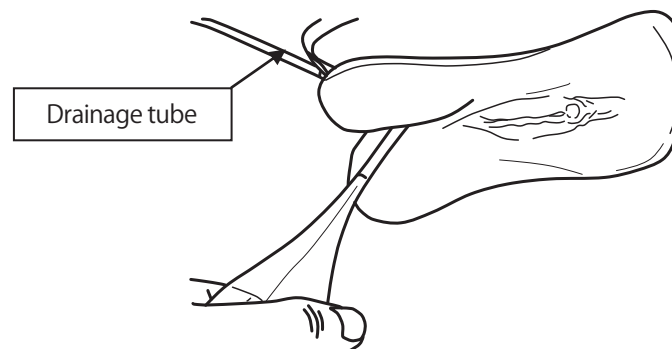

- Do not use any catheter other than the supplied catheter and simulated glycerin rectal injector. Practice with such a different catheter may damage the soft part of the model or cause water leakage.
- If the supplied catheter or simulated glycerin rectal injector is quickly inserted or removed, the sealing of the valve in the model may be lost resulting in water leakage. Slowly insert or remove it as you would do with the living body.
- After glycerin rectal injection, confirm that there is no water remaining in the pipe connecting the drainage tube connector to the model before removing the model. Since no one-way valve is provided in the anal region, liquid may flow back from that region.

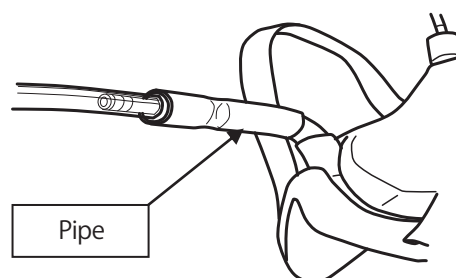

- Pulling the rubber band for the model with excessive force may damage the model.
- If after use the surface is found to be oily, apply powder to the surface.
- Never use solvent ink or paint, which will penetrate into the model and cannot be removed.
- Position the model in the proper orientation. Storing the model in the opposite orientation may deform it. If the model is stored with the tube bent, liquid may be prevented from flowing in the tube.
- The model applicable for glycerin rectal injection is marked "GLYCERIN" on its right side. If glycerin rectal injection is performed with the former model without the above marking, liquid leakage will result.

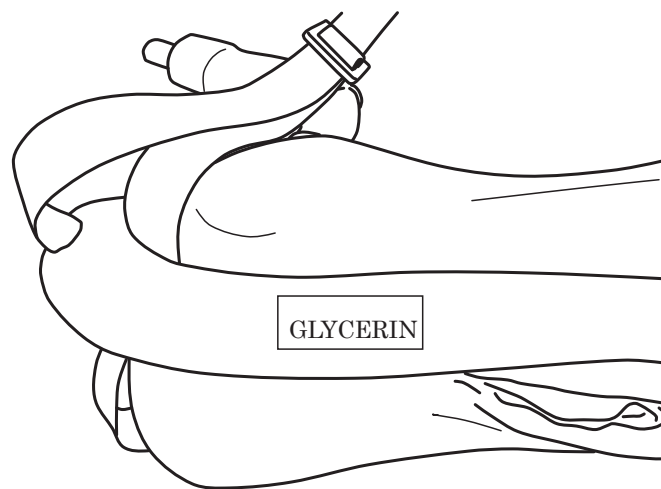

- The rectal injection procedure for this product is only applicable to glycerin rectal injection. With this product, do not perform the procedure for high-pressure rectal injection.
- This product is intended for use in standard operating environments. Do not use it in heavy industrial settings.
- This model uses urethane foam for some of its parts, and may be susceptible to damage from pests that are attracted to urethane foam (such as insects in the ant family).  
When storing this model, ensure that thorough measures are taken to prevent pest damage before storing. The company will not be involved with or held liable for pest damage that occurs during storage.

1. The contents of this instruction manual are subject to change without notice.
2. This instruction manual may not be reproduced in part or in its entirety without permission.
3. Please contact the manufacturer in the event that any errors or omissions are found in the contents of this instruction manual.
4. This product should be used only as described in this instruction manual. In particular, the product should not be used in any way that contravenes the precautions noted in the instruction manual.

## Table of Contents

1. Outline and Features
2. Structure and Name
3. Handling the Model
4. Caring for the Model
5. Specifications
6. Optional item (sold separately)
7. Replacement Parts (sold separately)

# 1. Outline and Features

## Outline

This product allows you to practice a series of procedural techniques for urethral catheterization and glycerin rectal injection when attached to the living body or a mannequin. The sensation of catheter insertion and that of the simulated valve are similar to those experienced when handling the real body parts.

When the catheter is inserted from the urethral orifice, urine (water) is extracted.

## Features

1. Since the product is made of our original silicon rubber, it is possible to practice urethral catheterization and glycerin rectal injection for adult females while experiencing lifelike sensations.
2. The model is wearable, allowing you to practice the procedures by wearing or putting it on a mannequin.
3. The model has a realistic shape so that observation and cleaning can be performed.
4. When the catheter is inserted from the urethral orifice, the user obtains lifelike sensations. Once it is properly inserted, urine (water) is extracted.
5. Glycerin rectal injection can be practiced from the anus.

## 2. Structure and Name

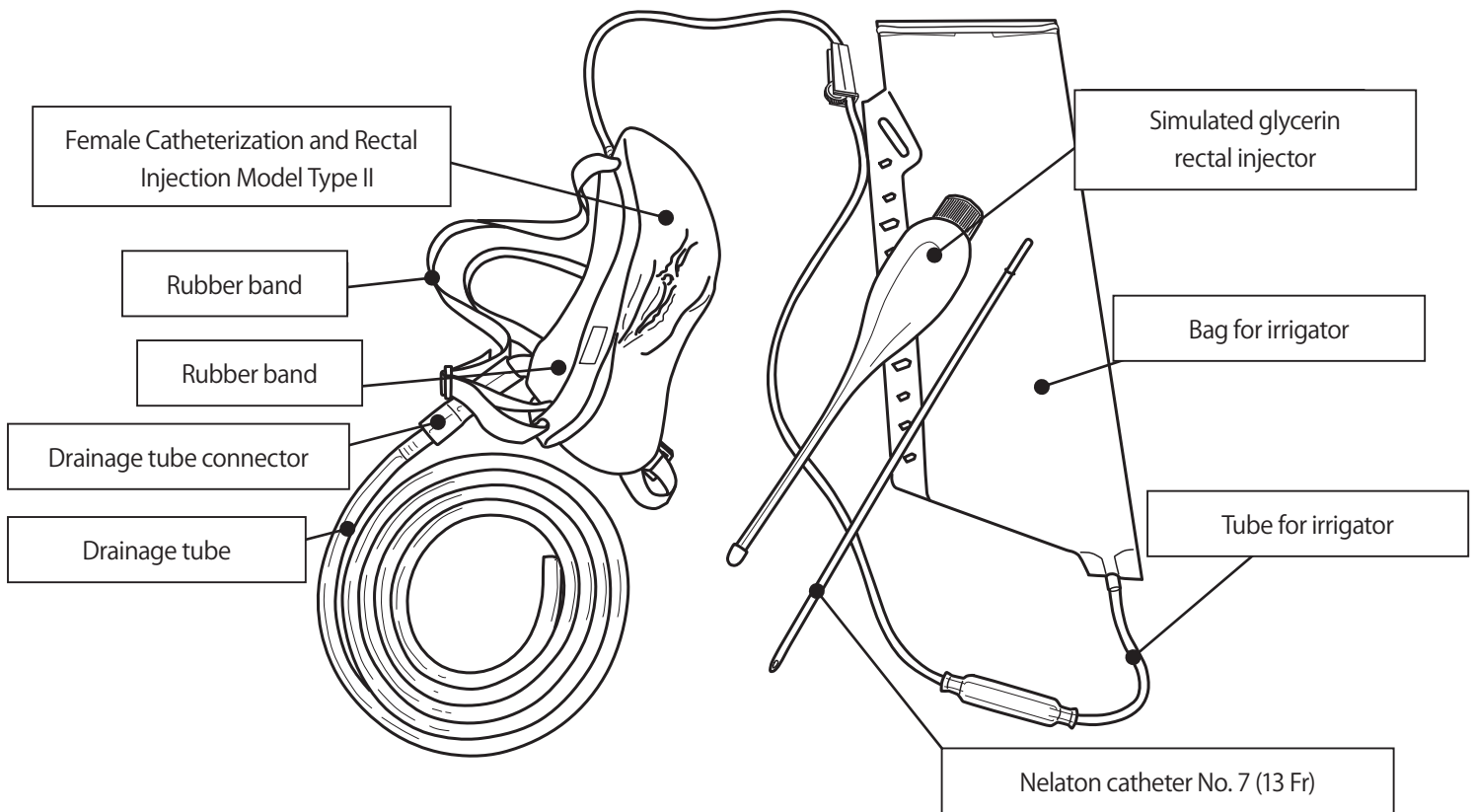

### 3. Handling the Model

#### ○ To practice urethral catheterization:

- Fully insert the tube connector into the end of the tube for irrigator.

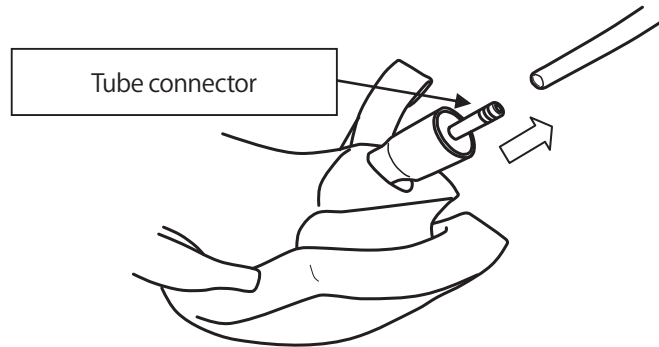

- After this insertion, fill the bag for irrigator with water and then adjust the flow rate using the roller clamp.

#### ○ To practice glycerin rectal injection:

- Fully insert the drainage tube connector into the drainage tube and lead the other end of the drainage tube to the container to receive drainage (this container is not attached).

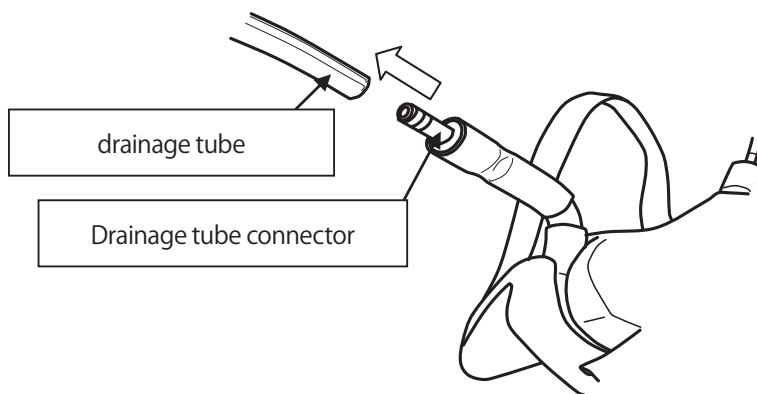

- In principle, use water for the simulated glycerin rectal injector that is included in the product.

## 4. Caring for the Model

- After use, thoroughly remove glycerin and other foreign matter using neutral detergent or the like.

Never use any solvent such as thinner or benzine, which will damage model.

After drying, apply powder and then store the model.

- To remove the sponge, slide it along the tube after removing the tube connector. Sliding the sponge without removing the tube connector causes damage to the tube.

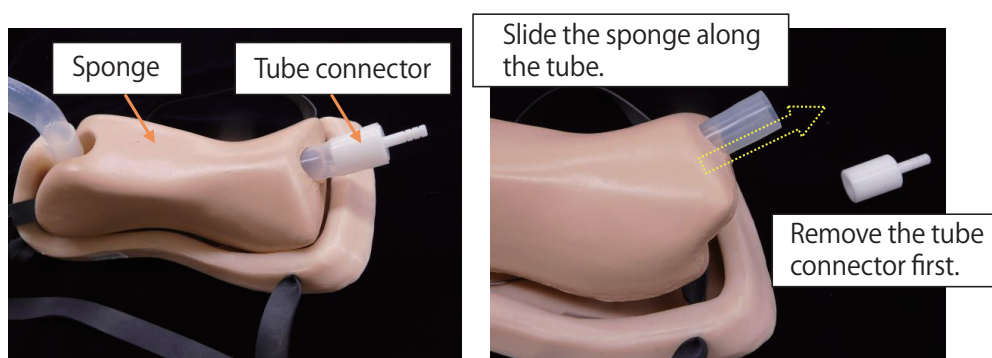

- Do not place any object on the model. This will deform the surface and other parts of the model. Avoid using or storing the model in a location exposed to high temperature.
- If the model is not used for a long period of time, put it in the attached case and store it.
- To store the model, choose a location where the model is not exposed to direct sunlight or ultraviolet rays. Such exposure for long hours will result in discoloration of the model.

## 5. Specifications

	Length	Width	Height	Weight
Main body	Approx. 22 cm	Approx. 10 cm	Approx. 15 cm	Approx. 340 g
Storage case	Approx. 26 cm	Approx. 22 cm	Approx. 13cm	Approx. 865 g

### Accessories

Bag for irrigator	1 piece
Simulated glycerin rectal injector	1 piece
N elaton catheter No. 7 (13 Fr)	1 piece
Drainage tube set (2 m)	1 piece
Instruction manual (this document)	1 copy



## 6. Optional item (sold separately)

- An attachment with a simulated male genital organ, which is attachable to Female Catheterization and Rectal Injection Model Type II, is available optionally.
- This attachment covers the front of Female Catheterization and Rectal Injection Model Type II, making it applicable as a wearable model for male rectal injection simulation.

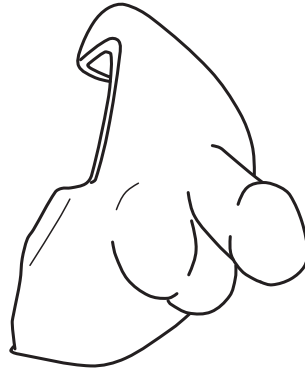

Note: This attachment provides no urethral catheterization capability.

Setting up the attachment

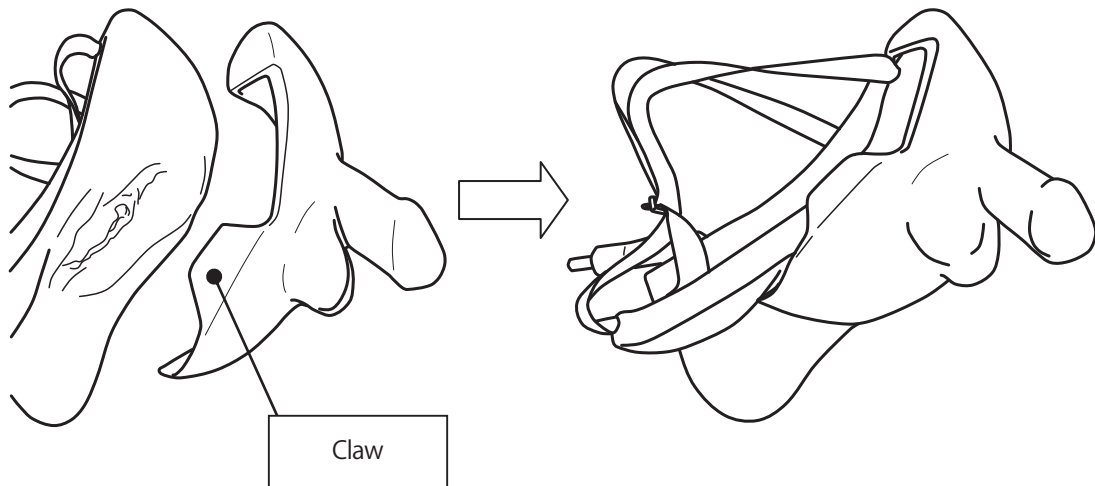

- Position the upper part of the attachment to the front of the model and then hook the claw to the lateral side of the model.

Product No.	Product name
LM-025A	Optional Male Genital Organ

## 7. Replacement Parts (sold separately)

- A replacement irrigator is available as a replacement part in case of breakage of the bag for irrigator.
- The replacement irrigator is also available as a bottle type irrigator in addition to the attached bag type. It can easily be replaced by changing the connector connecting the tube for irrigator to the irrigator. The connector can be removed by twisting counter-clockwise, and can be secured by twisting clockwise after inserting.



LM-025K  
Bottle for irrigator

Product No.	Product name
LM-025H	Tube for irrigator (3pcs/set)
LM-025J	Bag for irrigator (3pcs/set)
LM-025K	Bottle for irrigator
LM-025E	Elastic cord
LM-025G	Drainage tube set
LM-025S	Sponge
LM-025T	Tube connector
LM-0686	Glycerine enemator (with cap/5pcs)